

# Centri-Thrift Field Assembly Kits Parts List

125M-FA Series  
150M-FA Series  
200M-FA Series

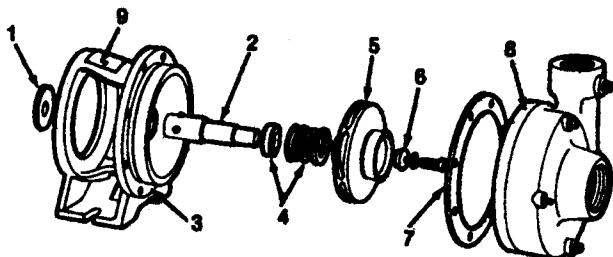

REF. NO.	PART NO.	DESCRIPTION
	16837A2 16837A14 16837A5 16837A15 16837A8 16837A16 16837A11 16837A12	Kit, Cat. No. 125M-2FA Kit, Cat. No. 125M-3FA Kit, Cat. No. 150M-2FA Kit, Cat. No. 150M-3FA Kit, Cat. No. 150M-5FA Kit, Cat. No. 200M-3FA Kit, Cat. No. 200M-5FA Kit, Cat. No. 200M-7½FA -- Kits consist of all listed
1	5059A318	Slinger - All units except 150M-5FA, 200M-5FA, 200M-7½FA
1	5059A321	Slinger - 150M-5FA, 200M-5FA, 200M-7½FA
2	11714B1	Shaft w/Set Screws -- 125M-2FA, 125M-3FA, 150M-2FA, 150M-3FA, 200M-3FA
2	11914B1	Shaft w/Set Screws -- 150M-5FA, 200M-5FA, 200M-7½FA
	5013A15	Screw, Set 5/16-18UNC x 5/16" long -- 2 Used on all units except 150M-5FA, 200M-5FA, 200M-7½FA
	6024A1	Screw, Set 3/8-16UNC x 3/8" long -- 2 Used on 150M-5FA, 200M-5FA, 200M-7½FA
3	11715D	Bracket - All 125M units, 150M-2FA, 150M-3FA, 200M-3FA
3	11912D	Bracket -- 150M-5FA, 200M-5FA, 200M-7½FA
	19101A16	Screw, Cap 3/8-16UNC x 1-1/8" -- 4 required on all units except 150M-5FA, 200M-5FA, 200M-7½FA
	19103A4	Screw, Cap 1/2-13UNC x 1-1/4" -- 4 required on 150M-5FA, 200M-5FA, 200M-7½FA
4	11716A1	Seal -- All units

REF. NO.	PART NO.	DESCRIPTION
5	11725B2	Impeller - 125M-2FA
5	11725B3	Impeller - 125M-3FA
5	12935B2	Impeller - 150M-2FA
5	12935B1	Impeller - 150M-3FA
5	12935B3	Impeller - 150M-5FA
5	12936B2	Impeller - 200M-3FA
5	12936B1	Impeller - 200M-5FA
5	12936B3	Impeller - 200M-7½FA
	5818A25	Key - 3/16 Sq. x 21/32" Long -- All units
6	11718A	Washer - All 125M units
6	12933A	Washer - All 150M, 200M units
	19100A4	Screw, Cap SST 5/16-18UNC x 3/4" -- All 125M units
	6106A8	Screw, Scoket Head SST 5/16-18UNC x 1" long -- All 150M, 200M units
	5454A14	Lockwasher, 5/16 SST -- All units
7	5863A13	Gasket - 125M, 150M, 200M units
8	11726D1	Case, Volute - All 125M units
8	12937D1	Case, Volute - All 150M units
8	12938D1	Case, Volute - All 200M units
	11720A	Ring, Wearing -- For 125M units w/wearing ring
	12934A	Ring, Wearing -- For 150M, 200M units w/wearing ring
	19101A16	Screw, Cap 3/8-16UNC x 1-1/8" -- 8 required on all units
	5022A4	Plug, Pipe 1/8" NPT -- 4 required on all units
	5022A9	Plug, Pipe 1/4" NPT -- 1 required on all units
9	22005A	Nameplate, Blank
	5160A1	Screw, Drive 1/8" x 1/4" - 2 required